

Hex Full Nuts

Tuercas alta

Ecrous six pans

A2
A4

Type B

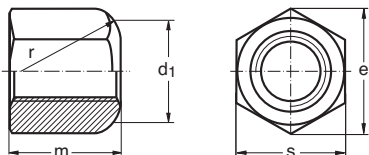

d H14	M8	M10	M12	M16	M20	M24	M30	M36	M42	M48
d ₁	9	11.5	14	18	22	26	32	38	44	52
e ~	15	19.6	21.9	27.7	34.6	41.6	53.1	63.5	75	86.5
m	12	15	18	24	30	36	45	54	63	72
s	13	17	19	24	30	36	46	55	65	75
pitch	1.25	1.5	1.75	2	2.5	3	3.5	4	4.5	5
r	11	15	17	22	27	32	41	50	58	67
W	9.6	21	31.5	61	120	206	419	715	1170	1800

(W ~ Weights of standard sizes in kilograms per 1000 pieces)