

**Prevailing Torque Hex Lock Nuts with polyamid insert**

**Tuercas gripco de seguridad**

**Ecrous de sécurité form basse avec rondelle en polyamide**

A2
A4

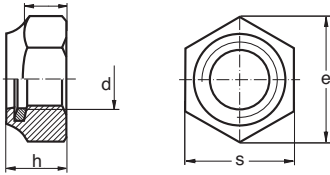

<b>d</b>	<b>M3</b>	<b>M4</b>	<b>M5</b>	<b>M6</b>	<b>M8</b>	<b>M10</b>	<b>M12</b>	<b>M14</b>	<b>M16</b>	<b>M18</b>	<b>M20</b>
e min.	6.01	7.66	8.79	11.05	14.38	18.90	21.10	24.49	26.75	29.56	32.95
h max.	4	5	5	6	8	10	12	14	16	18.5	20
m	2.4	2.9	3.2	4	5.5	6.5	8	9.5	10.5	13	14
s	5.5	7	8	10	13	17	19	22	24	27	30
pitch	0.5	0.7	0.8	1	1.25	1.5	1.75	2	2	2.5	2.5
W	0.50	1.00	1.40	2.40	5.10	10.6	17.2	26.0	34.0	45.0	65.0

<b>d</b>	<b>M22</b>	<b>M24</b>	<b>M27</b>	<b>M30</b>
e min.	35.03	39.55	45.2	50.85
h max.	22	24	27	30
m	15	15	17	19
s	32	36	41	46
pitch	2.5	3	3	3.5
W	75.0	100	162	212

(W ~ Weights of standard sizes in kilograms per 1000 pieces)